

RM65-H - Hydraulic Driven Remote Monitor

- Hydraulic cylinders control Left / Right Slew action.
- Automatic grease lubrication optional
- 90° slew (maximum)
- 70° Elevation (as standard)
 (45° above horizontal, 25° below horizontal)
- Electric 8-way Joystick controller supplied
- Hydraulic manifold fitted with pressure relief valve and flow control valve
- Unit pre-set to correct settings and tested prior to final packaging and dispatch
- 12v or 24v solenoid valves optional
- Mounting flange with fasteners included
- Actuated air valve included to control on/off with electric solenoid wired
- Optional hydraulic on/off available
- Optional remote foam/fog nozzle available
- Optional Radio Frequency (R.F.) Control available
- 65mm (2½") ANSI 150lb flanged inlet connection
- Director nozzle supplied as standard - 28mm (1¼") orifice. 60 metres water throw at 7 bar

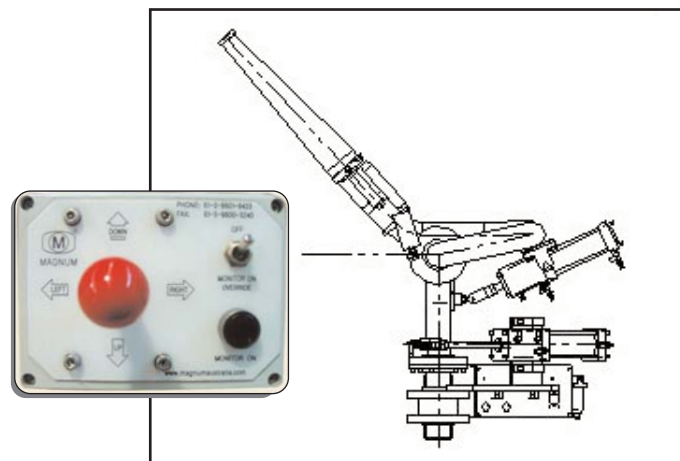
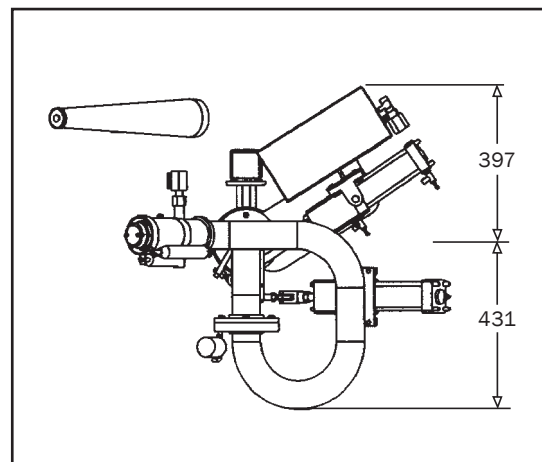
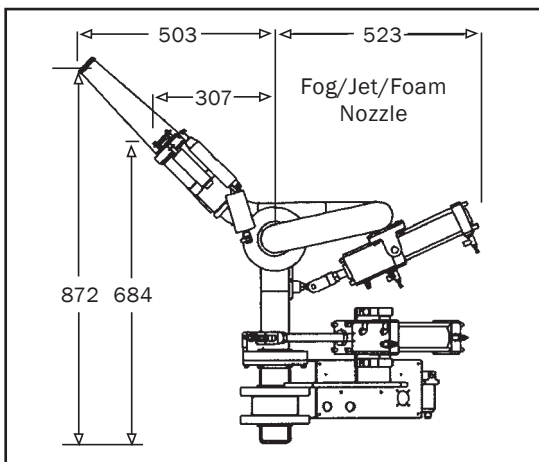
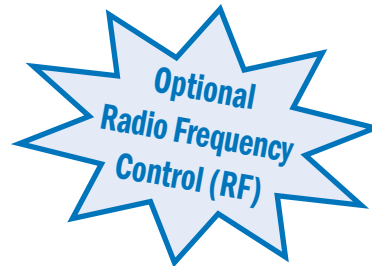

hydraulic driven remote monitor
RM65-H