

RM65-MK5 - Air Driven Remote Monitor

- Easy installation
- Pressure tested to 3000 kpa
- 65mm (2 ½") ANSI 150lb flanged inlet connection
- Pneumatic slew and elevation control
- Air cylinder drive offering up to 90° precision slew
- Air cylinder controlling 75° angle elevation
- Optional electric or pneumatic joystick cabin control as standard
- Radio Frequency (R.F.) control - optional
- Full automation via sequencing or PLC technology - can retro fit as optional
- Engineered balanced and compact design - see dimensions
- Positive lock air cylinders fitted for improved accuracy and control
- Designed for mobile or fixed mounted applications
- Patented "non-flog" Magnum® Australia swivel bearings
- Automatic grease lubrication optional
- Accepts Magnum 316 s/s fog nozzle for adjustable fan spray
- Optional 3% foam induction nozzle available for fire applications
- Fog/jet nozzle available as option
- Director nozzle supplied as standard - 28mm (1 1/8") orifice. 60 metre water throw at 7 bar
- All s/s fasteners and protective cabinet components
- 12 month product warranty
- Spare parts readily available
- Fully serviceable

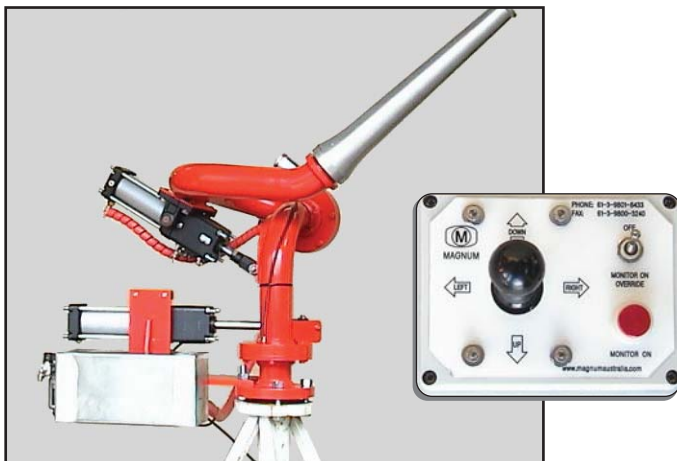
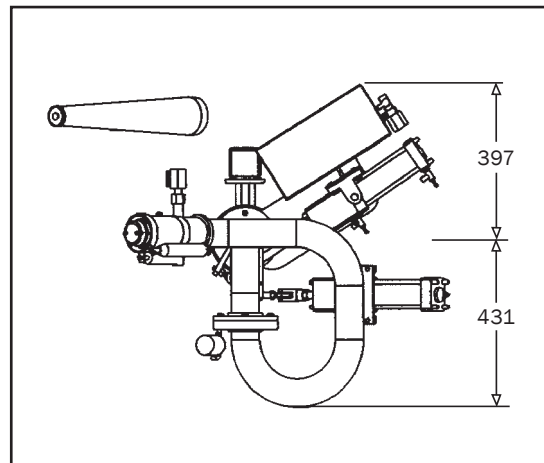
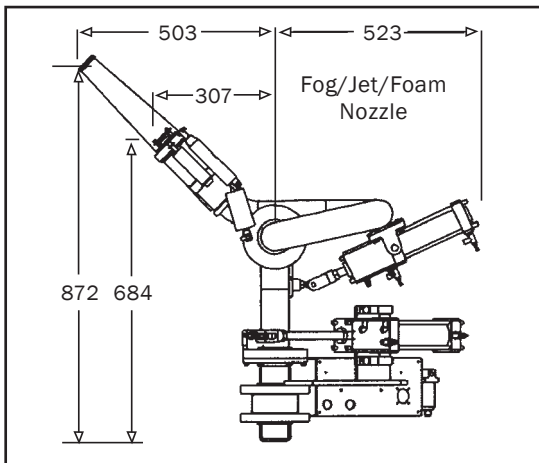

air driven remote monitor
RM65-MK5